

UltraMist™ Produce Misting System

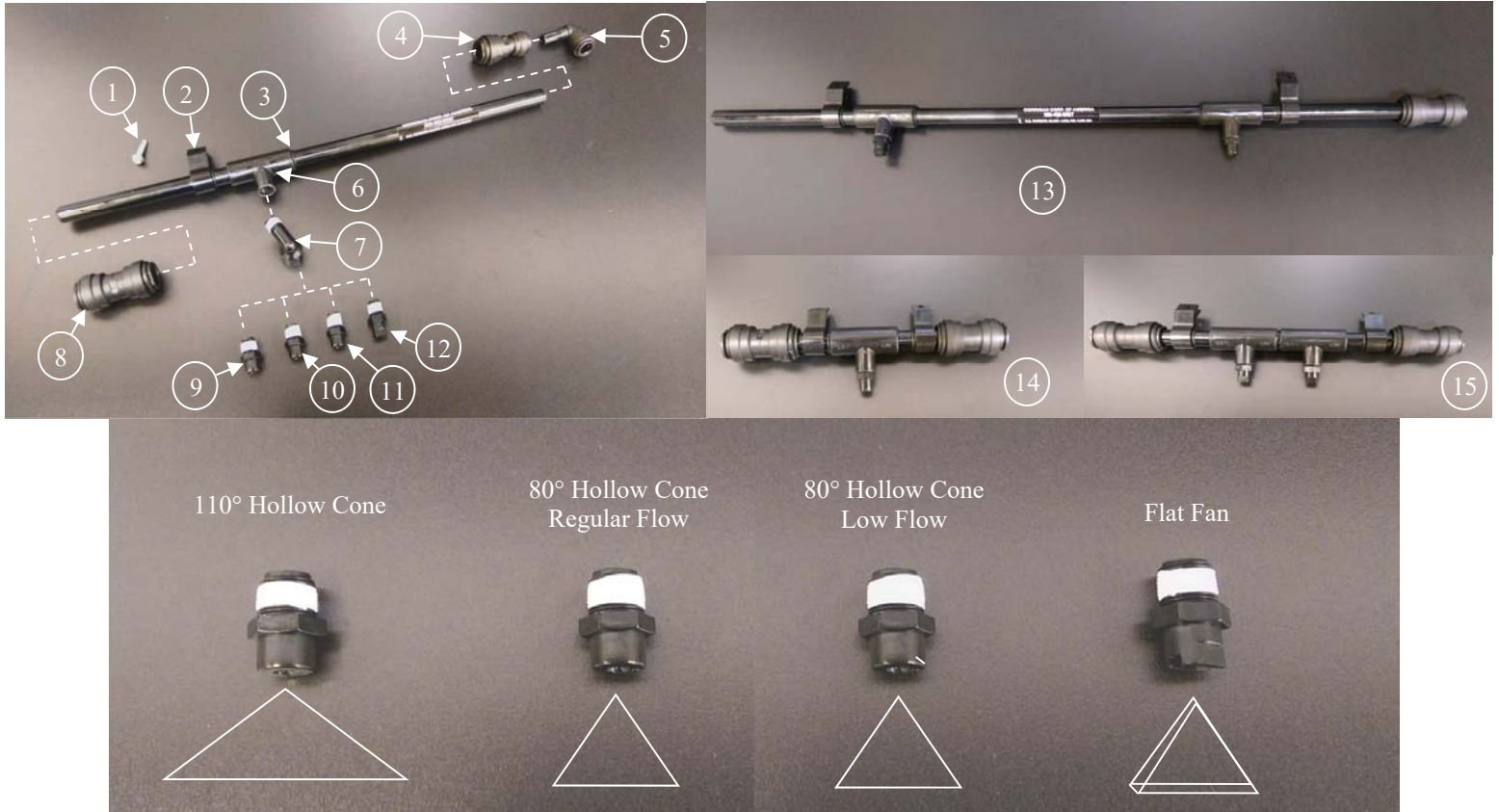

	Description	Part # in Black	Part # in White
1	Mounting screw	HSS317B	HSS317B
2	Mounting clamp	H444I	H444J
3	Retainer ring	CH524R	CH524Q
4	1/2" X 3/8" end feed coupler	JGRUC1238B	JGRUC1238
5	3/8" stem 90° connector	JGSEC38B	JGSEC38
6	Molded mist head	1001	1002
7	Swivel elbow (optional)	PPSE18B	PPSE18
8	1/2" union connector	JGUC12B	JGUC12
9	110° hollow cone nozzle	CNT110B	CNT110W
10	80° hollow cone nozzle- regular flow	CNT80B	CNT80W
11	80° hollow cone nozzle - low flow	CNT80BLF	CNT80WLF
12	Flat fan nozzle	CNT65FB	CNT65FW
13	Complete 2 foot section	CUSB	CUSW
14	Wedge section	CUWB1	CUW1
15	Wedge section	CUWB	CUW



Misting Control Panel ACP2N and ACP4N

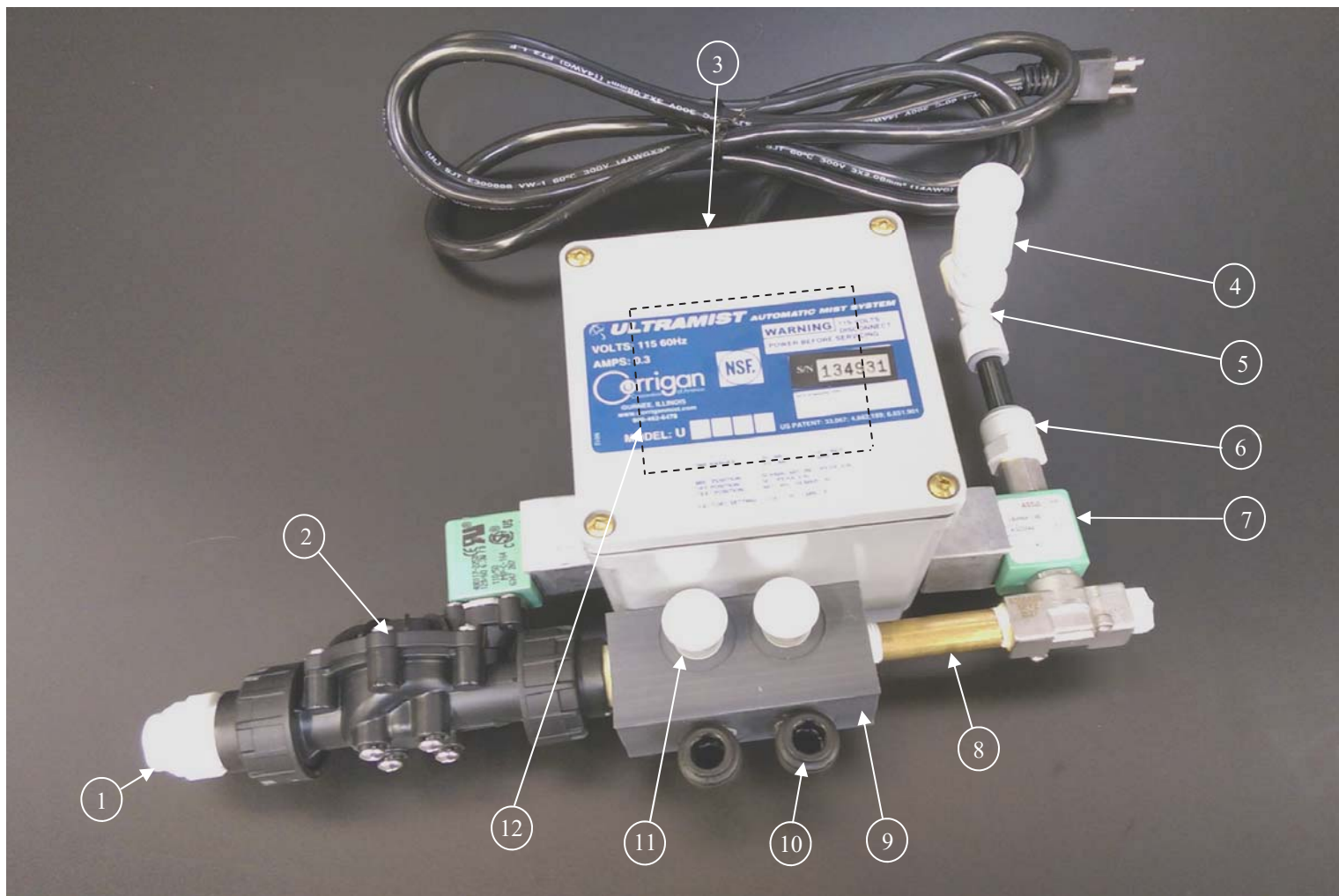

	Description	Part #
1	1/2" X 1/2" male connector	JGMC12
2	1/2" normally closed solenoid	SVNCP12120
3	On/off switch	E206A
4	Vacuum break	JGCV38
5	3/8" union tee	JGUTP38
6	3/8" X 1/4" male connector	JGMC3814
7	1/8" normally open solenoid	SVNO18120NSF
8	1/4" X 2 1/2" nipple	PBN14212
9	Manifold	CP
10	3/8" stem elbow connector	JGSECB
11	3/8" plug	JGTP38
12	Timer (not shown; inside box)	T202D



Model CSS2A Audio Warning Controller with Remote Solenoid and Que Audio Player

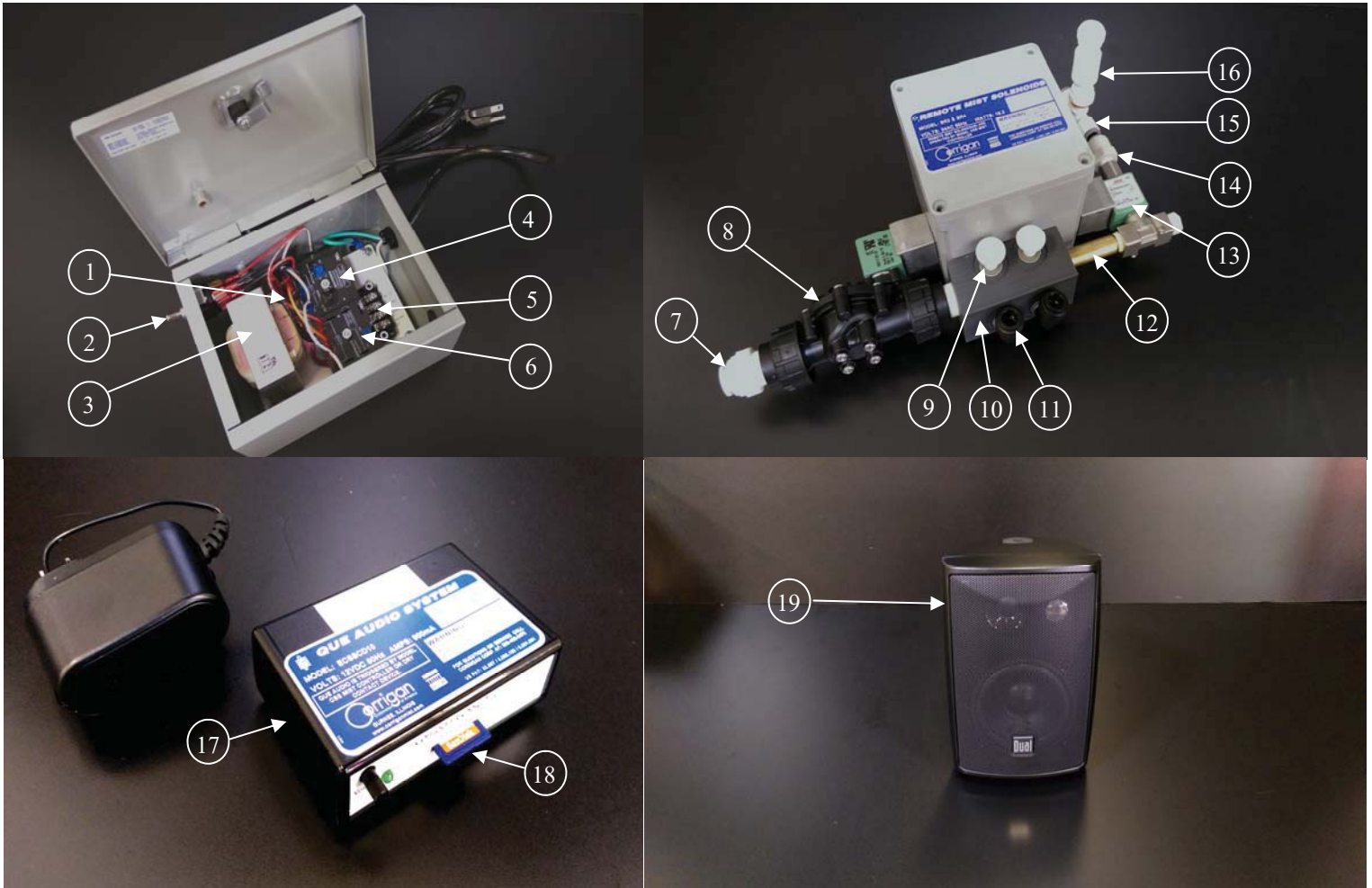

	Description	Part #
1	24 volt relay	ER204
2	On/off toggle switch	E206
3	24V transformer	ET15348
4	Timer module - OFF time	T202D
5	Terminal block	E2181
6	Timer module - ON time	T202G1
7	1/2" male tube adapter	JGMC12
8	1/2" normally closed solenoid	SVNCP1224
9	3/8" stem plug	JGTP38
10	Manifold block	CP
11	3/8" stem elbow	JGSEC38
12	1/4" X 2 1/2" nipple	PBN14212
13	1/8" normally open solenoid valve	SVNO1824NSF
14	3/8" X 1/4" male connector	JGMC3814
15	3/8" union tee	JGUTP38
16	Vacuum break	JGCV38
17	Que audio player with power transformer	ECSSCD10
18	Que flash card	ECSSCF
19	2 speaker set	ESPKR

